

BōT RōP®

The Perfect RōP For Your BōT

Installation Instructions

Tools Required

Pencil

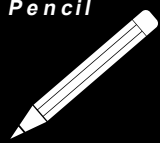

Corded Power Drill

7" Diameter
2" Depth
Hole Saw

+



or



Jig Saw

Phillips Head
Screw Driver



5/32" drill bit



or

Corded Power Drill with
Phillips Head Bit

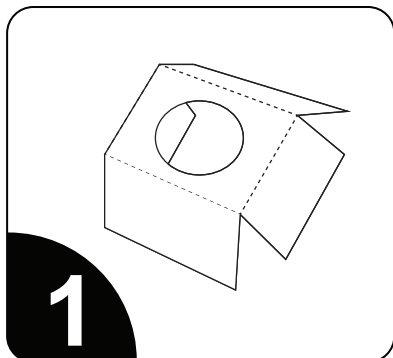

Open the package, remove the product, and locate the cutting template.
(If using the Drill / Hole Saw you can skip to step 3.)

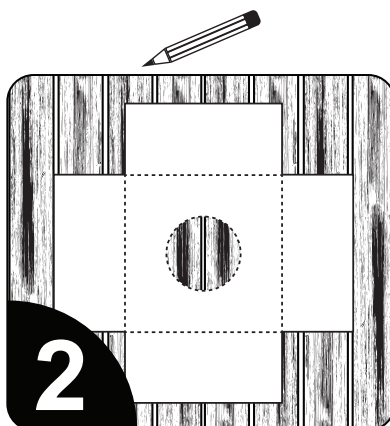

Lay the template on dock with the outer edge of the hole 3 inches from the edge of the dock. Avoid placing template over joist below the dock. Trace the circle opening with a pencil on the location where you will install the **BōT RōP**.

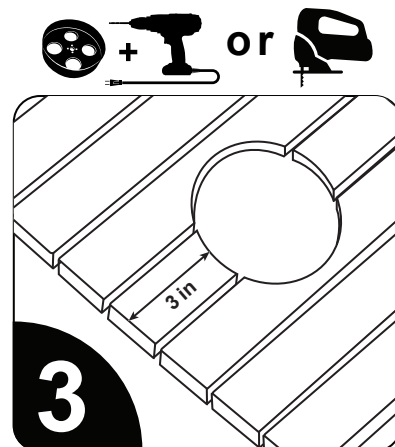

Remove the template and use the Power Drill with the Hole Saw Bit or the Jig Saw to cut on the pencil line to create the opening in the dock. Make sure the hole is 3 inches from the edge of the dock.

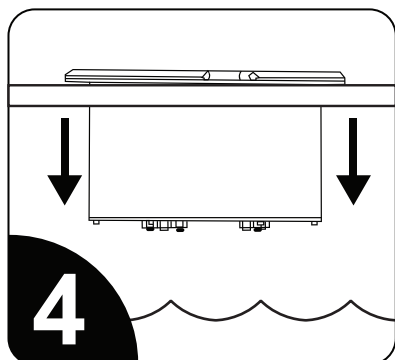

Place the **BōT RōP** in the opening in the dock with the logo side up allowing the majority of the unit to be suspended below the dock.

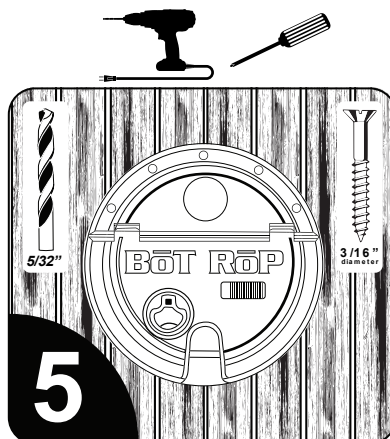

With the **BōT RōP** in place, use a 5/32 inch drill bit to pre-drill the 11 holes located around the top of the unit. Then secure the unit to the dock with the provided screws. Keep in mind that 6 holes are concealed under the lid.



Rust Prevention Spray recommended for maintenance or good upkeep (not included).



1

Lift up on the lockable latch to open the lid.

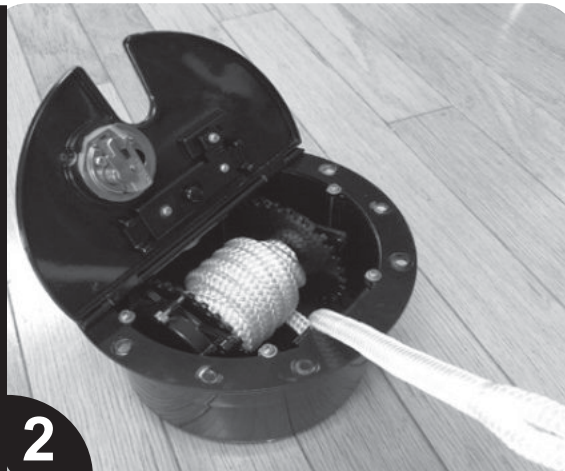

2

Pull on the end of the rope for the desired length necessary to reach your boat.

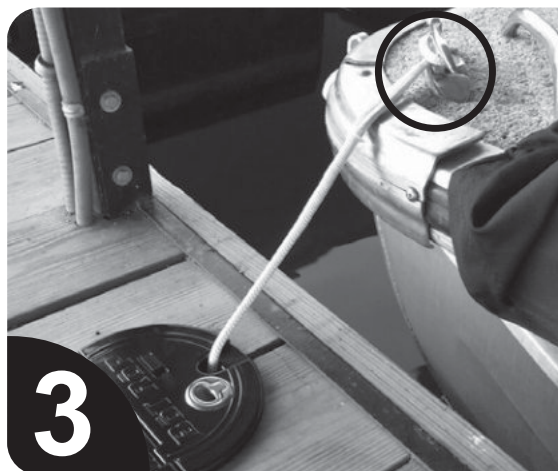

3

Whether using the *EYE* model or the *SNAP HOOK* model, simply attach the rope to your boat and close the lid.

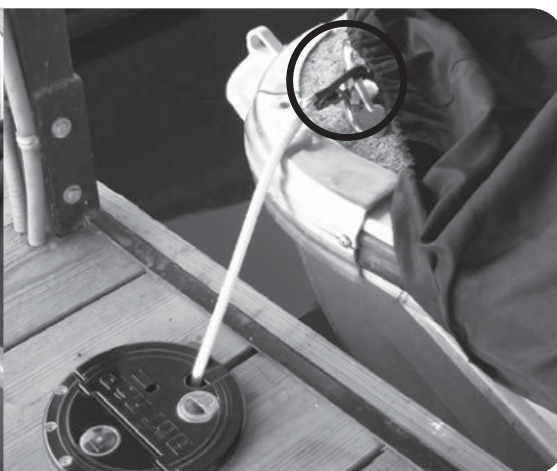

How To Change Out The Line

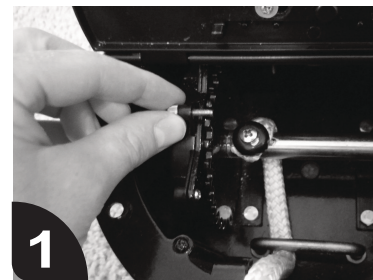

1

Pull the rope all the way out and screw the set screw into the spool.

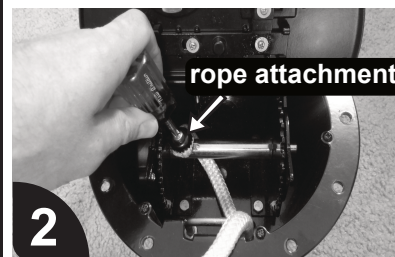

2

Unscrew the rope attachment.



3

Screw the new line into the rope attachment.

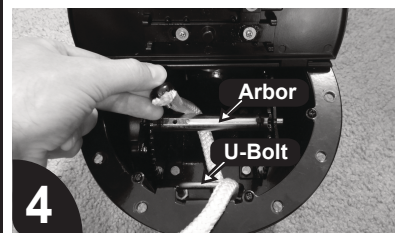

4

Tether the line back underneath the u bolt, then the arbor and screw the new rope into the arbor.

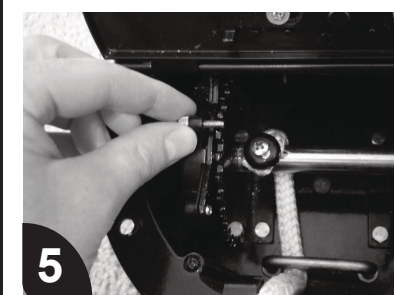

5

Unscrew the set screw to release the rope back into the canister.



4

With the rope attached securely to the boat, you can push the *Tidal Adjustment Switch* to the right. This allows the rope to extend and retract freely in rough or tidal conditions. If you push the switch to the left, it locks the rope into place.

When not mooring your boat, simply untie the rope from your boat and lift the lid to retract the rope into the unit.

